

Assembly Instructions

Before you begin, please make sure all parts and proper quantities are included. Any parts damaged during shipment must be reported within 5 days of receipt. To report information regarding damages or if you have any questions, please call 800.242.2303.

Part	Description
A	Side Panel (right side)(lay this panel on the floor)
B	Subtop Panel
C	Shelves w/Lotz Armor Edge™
D	Bottom Panel w/Lotz Armor Edge™
E	Middle Panel
F	Back Panel
G	Toe Kick
H	Side Panel (left side)

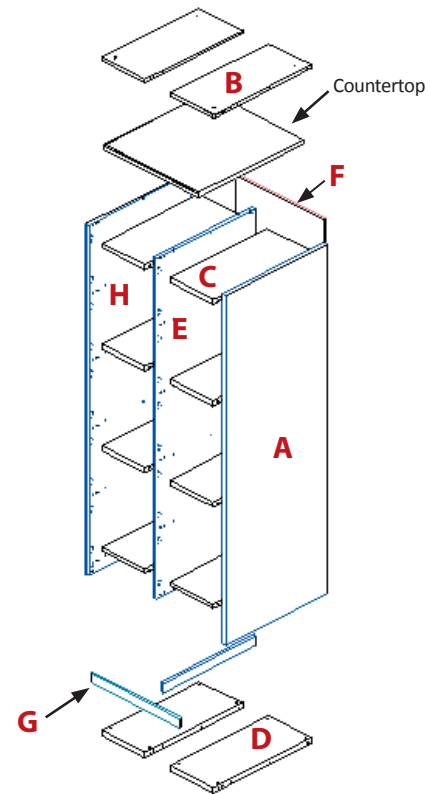

Step 1:

Start assembly with **side panel(A)** on a protected floor with dowel holes facing up. (The back edge has dowel holes aligned from top to bottom.)

Step 2:

Align the dowels of **subtop panel(B)** with the holes on side panel(A). (TFL edge of subtop panel(B) will need to face to the front of the cabinet and you will need to apply an **adhesive PVA white glue*** to the dowels.)

Step 3:

Align the dowels of the Lotz Armor Edge™ **shelf(C)** with the holes on side panel(A). (Radius front edge of the shelf will need to face to the front of the cabinet and you will need to apply an **adhesive PVA white glue*** to the dowels.) You will need to repeat this for the remaining shelves on the right hand side.

Step 4:

Align the dowels of **bottom panel w/ Lotz Armor Edge™(D)** with the holes on side panel(A). (Make sure the holes for the levelers are facing the outside edge of the cabinet and you need to apply an **adhesive PVA white glue*** to the dowels.)

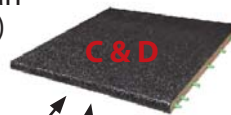

Step 5:

Align the dowel holes of the **middle panel(E)** with the dowels on each of the shelves (You need to apply an **adhesive PVA white glue*** to the dowels on the shelves.)

Step 6:

You will now need to repeat **Steps 2-4** to assemble the left side of cabinet (Don't forget to always apply an **adhesive PVA white glue*** to the dowels.)

Step 7:

Align the dowels of **back panel(F)** with the holes on side panel(A). (You will need apply an **adhesive PVA white glue*** to the dowels.)

*Adhesive PVA white glue and clamps are not provided.

Assembly Instructions-Cont.

Before you begin, please make sure all parts and proper quantities are included. Any parts damaged during shipment must be reported within 5 days of receipt. To report information regarding damages or if you have any questions, please call 800.242.2303.

Part	Description
A	Side Panel (right side)(lay this panel on the floor)
B	Subtop Panel
C	Shelves w/Lotz Armor Edge™
D	Bottom Panel w/Lotz Armor Edge™
E	Middle Panel
F	Back Panel
G	Toe Kick
H	Side Panel (left side)
I	Toe Rail
J	Levelers (set of 4)
K	Countertop
L	Music Cabinet Grille Doors (left hand)
M & N	Black Magnet Catch(M) on Door Latch(N)

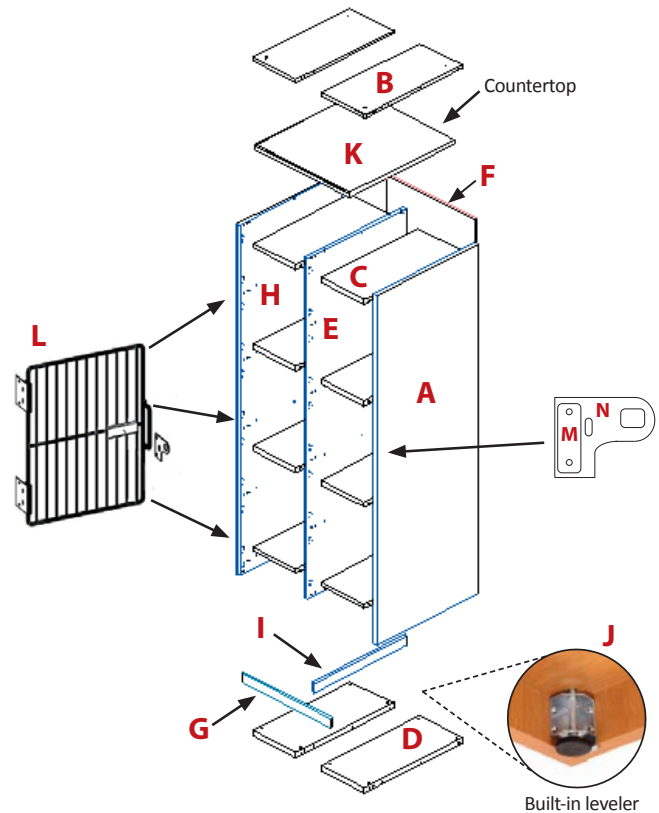

Step 8:

Align the dowels of **toe kick(G)** with holes on side panels(A). (You will need apply an **adhesive PVA white glue*** to the dowels.)

Step 9:

Align the dowel holes of **side panel(H)** with the dowels on panels(B, D, F & G). (You will need apply an **adhesive PVA white glue*** to the dowels on panels B, D, F & G.) (B & D panels will be the left hand side of those panels.)

Step 10:

Install **toe rail(I)** using 1 ½" face frame screws

Step 11:

Install the **levelers(J)** using #6x ½" zinc Phillips screws in each corner of bottom panel(D).

Step 12:

Stand cabinet upright (ask for help).

Step 13:

Install **countertop(K)** over subtop panel(B) using ¼-20x30mm black joint connector bolts.

Step 14:

Align **grille doors(L)** (left hand) with pre-drilled holes using black #8x ⅝" flat head wood screws.

Step 15:

Align screw holes on **black magnet catch(M)** and **door latch(N)** and then use 2, 6x ¾" black pan screws to attach magnet catch(M) and door latch(N) to the inside of side panel(A). Use 1 #8x ⅝" flat head wood screw to further secure door latch(N) to inside of side panel(A).

Step 16:

WB Mfg. would recommend applying clamps* (not provided) down the sides of panels E & A and A & H.

*Adhesive PVA white glue and clamps are not provided.